



What to Expect During Construction



Maryland Transportation Authority

What you should know about construction efforts, congestion relief and work zone safety

HOW WILL IT AFFECT YOU?

As a result of the construction work scheduled in the coming months, you may experience some noise and notice added dust in your neighborhood caused by the following activities and operating equipment:

- Pavement breaking
- Paving/resurfacing
- Bridge deck removal
- Back-up alarms
- Milling/grinding machines
- Crane equipment
- Forklifts
- Night work
- Generators/compressors
- Backhoes
- Pile driving
- Earthmovers
- Bulldozers

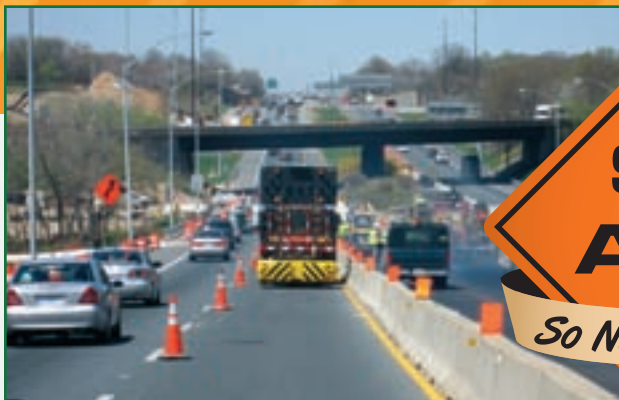

So No One Gets Hurt!

All four lanes of I-95 will be open in each direction during peak travel periods. Periodic lane closures on I-95 and detours will occur.

Questions? Comments? Contact:

I-95 Express Toll Lanes Project Office • 8019 Corporate Drive, Suite F • White Marsh, MD 21236
Toll Free: 1-888-195-ETLs • Phone: 410-931-0808 • I-95ExpressTollLanes.com

ETLsSM are coming soon!

In July 2005, the Maryland Transportation Authority (MdTA) received federal approval to construct Express Toll LanesSM (ETLs)SM on the most congested portion of I-95 north of Baltimore City. This 10-mile segment stretches from the I-895 split in N.E. Baltimore, to north of MD 43 (White Marsh Boulevard).

What are ETLs?

ETLs are new travel lanes that give motorists the option of paying a fee to drive in separate, less-congested highway lanes. Widening of I-95 will result in two ETLs and four general-purpose (free) lanes in each direction.

But that's not all – more improvements to come with the ETLs project.

New bridge overpasses and interchange improvements at I-895, I-695 and MD 43 are also part of this congestion-relief project. Completion is on schedule for 2011. Periodic detours and closures will occur.

Please check our website **I-95ExpressTollLanes.com** for the latest construction activities, interactive project-area maps, renderings of the future I-95, the ETL project video, and current traffic advisories.

**I-95 Express Toll Lanes
Project Office**

8019 Corporate Drive, Suite F
White Marsh, MD 21236



Maryland
Transportation
Authority



I-95ExpressTollLanes.com



EXPRESS
INTERSTATE
95
TOLL LANESSM

CONSTRUCTION IS RAMPING UP

on I-95 Express Toll LanesSM (ETLSM) between Rossville and Campbell Boulevards

I-95 will be widened to six lanes in each direction between Rossville Boulevard and Campbell Boulevard. This phase of construction will extend approximately two miles along I-95 and will join ongoing construction at the I-95/I-695 interchange. This mainline I-95 construction has just begun and is scheduled for completion in October 2009.

Periodic detours and lane closures will occur. Please visit I-95ExpressTollLanes.com, for the latest construction updates or stop by the Project Office in White Marsh.